

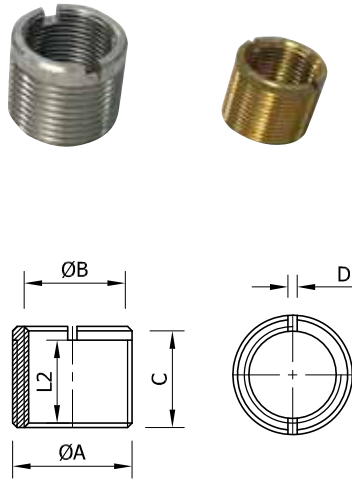
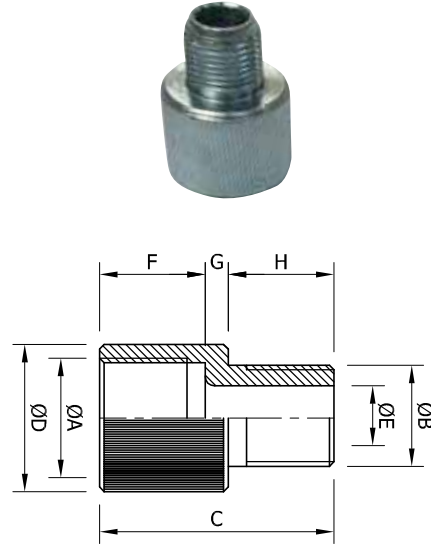

**RE**

**REB**

Tipi	Ağırlık (kg) Weight	A		B		C	D
		NPT	METRIC	NPT	METRIC		
RE.21*	0.05	3/4"	M25x1.5	1/2"	M20x1.5	22	2
RE.31	0.07	1"	M32x1.5	1/2"	M20x1.5	29	5
RE.32	0.07			3/4"	M25x1.5	29	5
RE.41	0.09	1 1/4"	M40x1.5	1/2"	M20x1.5	29	5
RE.42	0.09			3/4"	M25x1.5	29	5
RE.43	0.09	1 1/2"	M50x1.5	1"	M32x1.5	29	5
RE.51	0.10			1/2"	M20x1.5	29	5
RE.52	0.10	2"	M60x1.5	3/4"	M25x1.5	29	5
RE.53	0.10			1"	M32x1.5	29	5
RE.54	0.10	2 1/2"	M75x1.5	1 1/4"	M40x1.5	29	5
RE.61	0.17			1/2"	M20x1.5	29	6
RE.62	0.17	3"	M90x2	3/4"	M25x1.5	29	6
RE.63	0.17			1"	M32x1.5	29	6
RE.64	0.17	3"	M90x2	1 1/4"	M40x1.5	29	6
RE.65	0.17			1 1/2"	M50x1.5	29	6
RE.71	0.26	3"	M90x2	1/2"	M20x1.5	31	6
RE.72	0.26			3/4"	M25x1.5	31	6
RE.73	0.29	3"	M90x2	1"	M32x1.5	31	6
RE.74	0.29			1 1/4"	M40x1.5	31	6
RE.75	0.29	3"	M90x2	1 1/2"	M50x1.5	31	6
RE.76	0.29			2"	M60x1.5	31	6
RE.81	0.43	3"	M90x2	1/2"	M20x1.5	31	6
RE.82	0.43			3/4"	M25x1.5	31	6
RE.83	0.43	3"	M90x2	1"	M32x1.5	31	6
RE.84	0.43			1 1/4"	M40x1.5	31	6
RE.85	0.45	3"	M90x2	1 1/2"	M50x1.5	31	6
RE.86	0.45			2"	M60x1.5	31	6
RE.87	0.62	3"	M90x2	2 1/2"	M75x1.5	31	6

Malzeme : Çelik, RE.21pirinç veya çelik / Material: Steel, RE 21. Steel or Brass  
Ölçüler mm'dir. / Dimensions in mm.

Tipi	Ağırlık (kg) Weight	A		B		C	D	E	F	G	H
		NPT	METRIC	NPT	METRIC						
REB.21	0.07	3/4"	M25x1.5	1/2"	M20x1.5	51	32	14	23	5	23
REB.31	0.12	1"	M32x1.5	1/2"	M20x1.5	57	41	14	29	5	23
REB.32	0.13			3/4"	M25x1.5	57	41	19	29	5	23
REB.41	0.19	1 1/4"	M40x1.5	1/2"	M20x1.5	57	50	14	29	5	23
REB.42	0.19			3/4"	M25x1.5	57	50	19	29	5	23
REB.43	0.22	1 1/2"	M50x1.5	1"	M32x1.5	63	50	24	29	5	29
REB.51	0.37			1/2"	M20x1.5	57	58	14	29	5	23
REB.52	0.37	2"	M60x1.5	3/4"	M25x1.5	57	58	19	29	5	23
REB.53	0.37			1"	M32x1.5	63	58	24	29	5	29
REB.54	0.37	2 1/2"	M75x1.5	1 1/4"	M40x1.5	63	58	32	29	5	29
REB.61	0.48			1/2"	M20x1.5	57	69	14	29	5	23
REB.62	0.48	3"	M90x2	3/4"	M25x1.5	57	69	19	29	5	23
REB.63	0.48			1"	M32x1.5	63	69	24	29	5	29
REB.64	0.48	3"	M90x2	1 1/4"	M40x1.5	63	69	32	29	5	29
REB.65	0.48			1 1/2"	M50x1.5	63	69	38	29	5	29
REB.71	0.60	3"	M90x2	1/2"	M20x1.5	60	87	14	32	5	23
REB.72	0.62			3/4"	M25x1.5	60	87	19	32	5	23
REB.73	0.62	3"	M90x2	1"	M32x1.5	66	87	24	32	5	29
REB.74	0.68			1 1/4"	M40x1.5	66	87	32	32	5	29
REB.75	0.69	3"	M90x2	1 1/2"	M50x1.5	66	87	38	32	5	29
REB.76	0.69			2"	M60x1.5	66	87	49	32	5	29
REB.81	0.70	3"	M90x2	1/2"	M20x1.5	60	100	14	32	5	23
REB.82	0.71			3/4"	M25x1.5	60	100	19	32	5	23
REB.83	0.94	3"	M90x2	1"	M32x1.5	66	100	24	32	5	29
REB.84	0.94			1 1/4"	M40x1.5	66	100	32	32	5	29
REB.85	0.94	3"	M90x2	1 1/2"	M50x1.5	66	100	38	32	5	29
REB.86	0.94			2"	M60x1.5	66	100	49	32	5	29
REB.87	1.17	3"	M90x2	2 1/2"	M75x1.5	69	100	65	32	5	32